

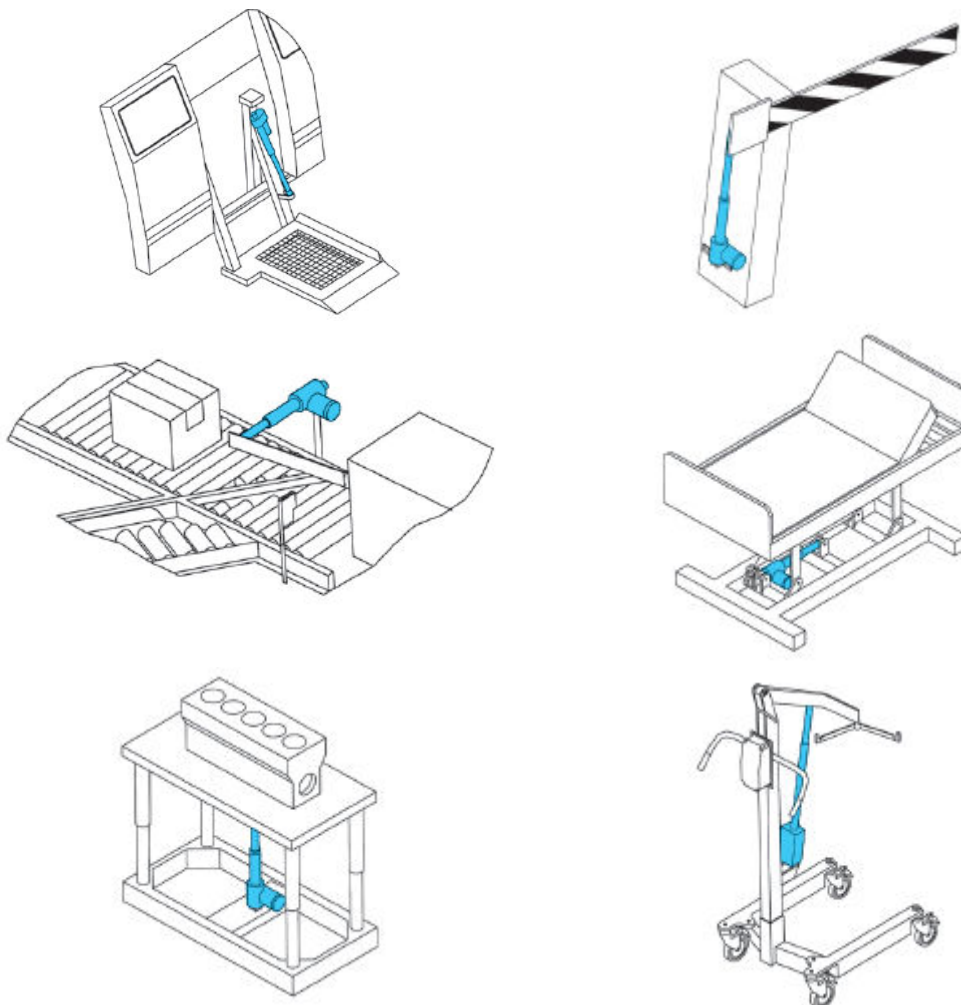

## Linear Actuators

A linear actuator is a versatile device that can be thought of as an electrical pneumatic or hydraulic cylinder. These actuators are at their best in intermittent applications such as windows, gates and doors, office automation, home care, traffic facilities, automatic throttles and low duty automation project.

Linear actuators are user friendly, competitively priced and easy to install with a simple 2-wire system. Feedback options allow for more complex control systems or use of control and keypads allow for plug and play installation. Manufacturing is to ISO9000 and many types are CE rated.



Installations must not place torsion, bending or impact on the actuator. As the actuators use sealed DC motors and plain screw shafts care must be taken to observe the duty cycle or life of the actuator will be compromised.



## LAM3 industrial actuator



High load 24V and 12V actuator for heavy-duty applications.

Easy two wire input cable, Duty cycle based on full load. Actuator comes complete with internal limit switches.

240V LAK2D controller mounts directly to the actuator available from stock.

LAM3-1 types stocked in NZ in IP65, other types available on indent.

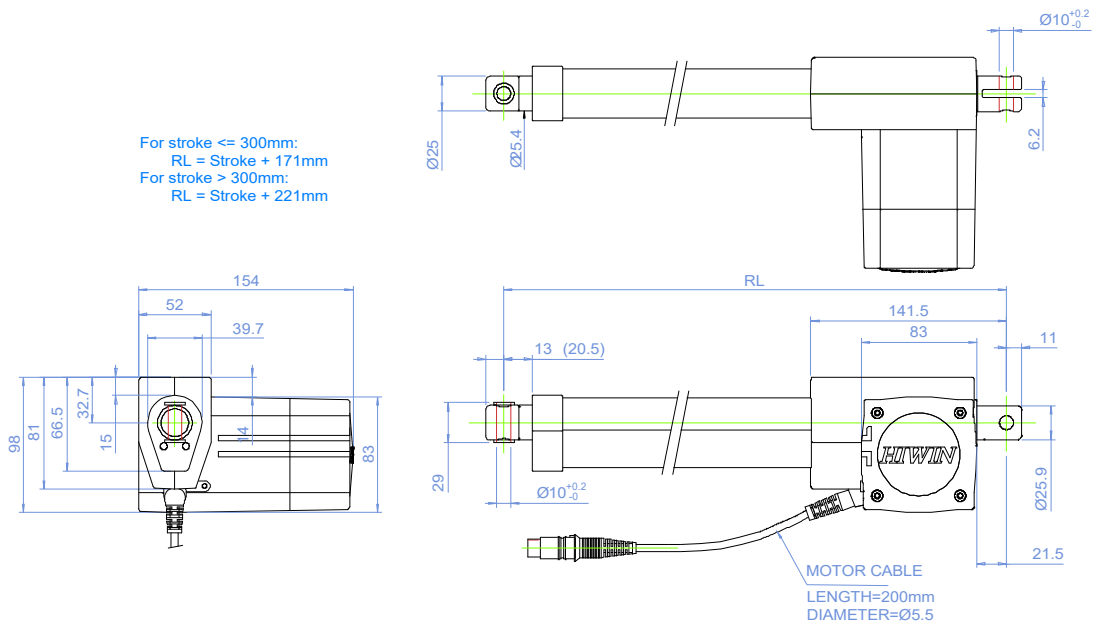

Model	Thrust (N)	Pulling (N)	Holding Force (N)	Speed (mm/s)	Standard Stroke (mm)								Duty Cycle %	Max Current (A)
				Load/no load	50	100	150	200	250	300	350	400		24VDC
LAM3-1	6000	5000	5000	4/5.5	50	100	150	200	250	300	350	400	10	6
LAM3-2	4000	4000	4000	5.5/7.5	50	100	150	200	250	300	350	400	10	5
LAM3-3	3000	3000	3000	7/9	50	100	150	200	250	300	350	400	10	4
LAM3-4	2000	2000	1500	11.5/14.5	50	100	150	200	250	300	350	400	10	4



**LAN1 actuator**



High load 12V actuator for heavy-duty applications.

Easy two wire input cable, Duty cycle based on full load. Actuator comes complete with internal limit switches.

LAK4 controller can be mounted directly to the actuator.  
Model is being phased out.

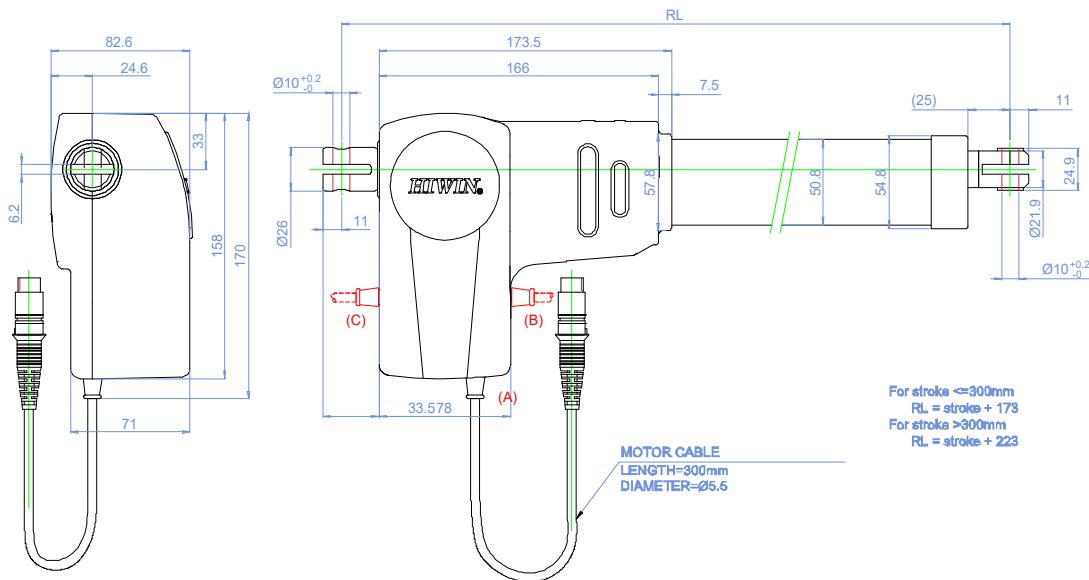

Model	Thrust (N)	Pulling (N)	Holding Force (N)	Speed (mm/s)	Standard stroke (mm)								Duty Cycle %	Max Current (A)
					100	150	200	250	300	350	400	12VDC		
LAN1-1	5000	5000	5000	3/6	100	150	200	250	300	350	400	10	11	
LAN1-2	4000	4000	4000	4/8	100	150	200	250	300	350	400	10	11	
LAN1-3	3000	3000	3000	5/10	100	150	200	250	300	350	400	10	10	

Can be supplied as 24V with a wide variety of options including;

- Position feedback
- Safety nuts
- Mechanical spline
- Quick release



## LAS1/2 compact actuator



Great actuator for a wide variety of applications including shutters, doors, remote controls, hatches, home automation and windows.

12V or 24V with 2 wire connection. Duty cycle based on full load. Actuator comes complete with internal limit switches.

LAS-1 and LAS-2 stock in NZ. Not suitable for direct exposure to sun and rain.

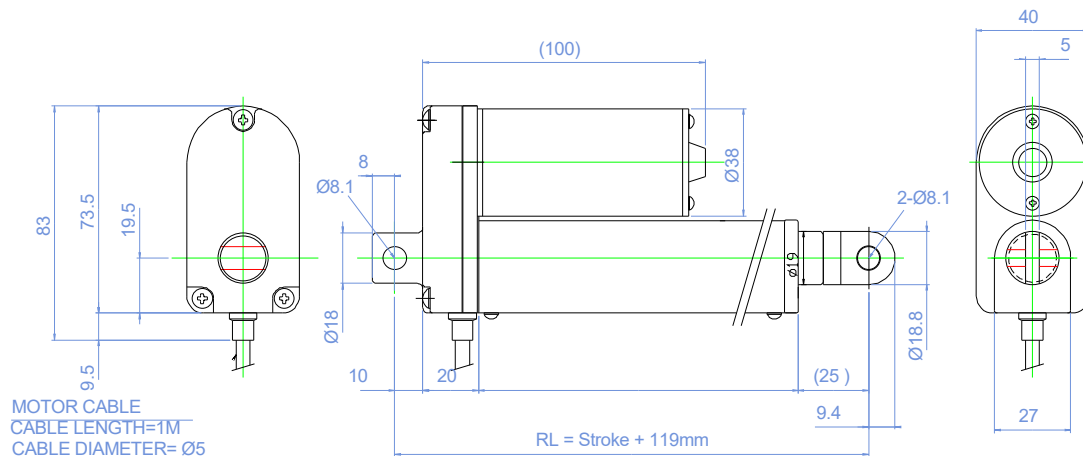

Model	Thrust (N)	Pulling (N)	Holding Force (N)	Speed (mm/s) load/No load	Standard Stroke (mm)						Duty Cycle %	Max Current (A)	
												12V DC	24V DC
LAS-1	1200	1200	800	8/12	25	50	100	150	200	250	10	6	2.5
LAS-2	600	600	300	16/25	25	50	100	150	200	250	10	6	3

Also available is the similar LAS3 type with potentiometer or optical (pulse) feedback.





**LAS4 compact actuator**



Elegant design ideal for architectural and exposed applications.

12V or 24V with 2 wire connection. Duty cycle based on full load. Actuator comes complete with internal limit switch.

Not suitable for direct exposure to sun and rain.

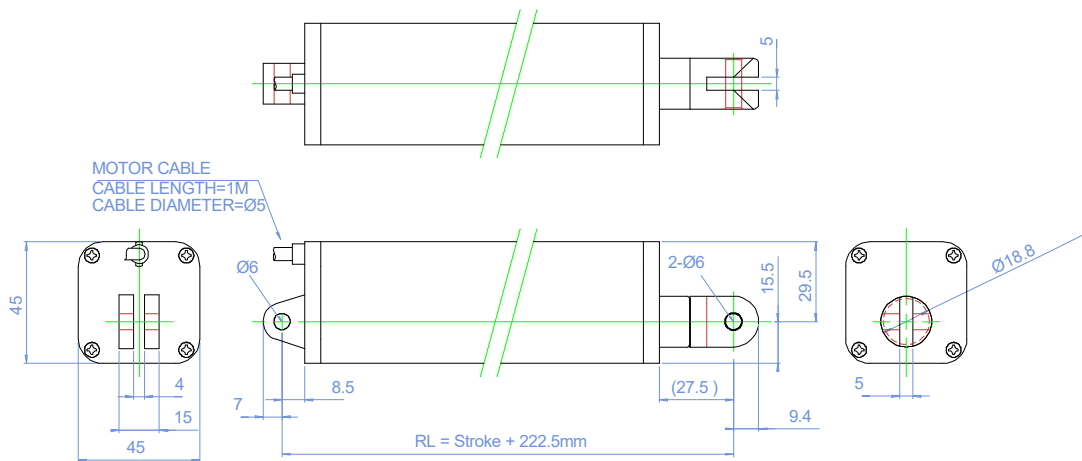

Model	Thrust (N)	Pulling (N)	Holding Force (N)	Speed (mm/s) load/No load	Standard Stroke (mm)					Duty Cycle %	Max Current (A)	
					100	150	200	250	300		12VDC	24VDC
<b>LAS4-1</b>	<b>800</b>	<b>800</b>	<b>600</b>	<b>10/15</b>	100	150	200	250	300	10	5	1.8
LAS4-2	300	300	200	30/46	100	150	200	250	300	10	6	3.6



## ***CI72 controller***

Highly capable controller with synchronise function and or overload protection.



- Control 12 or 24V actuators up to 25Amp
- Simple DIP switch setup
- Adjustable 10 step 2-25A current protection
- Single or dual actuator control
- Servo control option – analogue position
- Adjustable soft start
- Synchronous move with POT or hall actuators
- Din rail mount



## ID10 Ball screw industrial actuator



Heavy industrial actuator with built in clutch, higher duty cycle. High load ball screw model.

12V or 24V with 2 wire connection. Duty cycle based on full load. Limit switch model can be adjusted.

**Standard**

**Potentiometer/Limit switches**

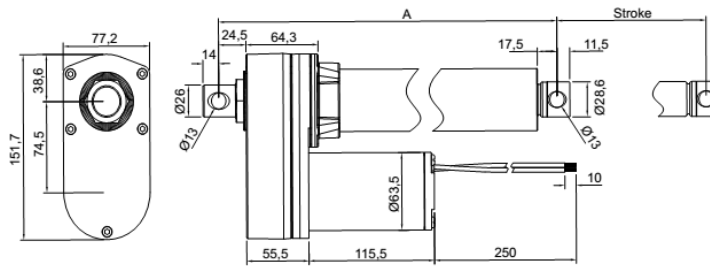

Standard model

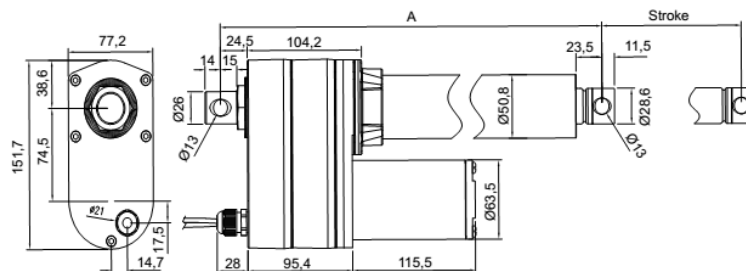

With Limit switches and or POT

Ratio	Thrust (N)	Pulling (N)	Static Load (N)	Speed (mm/s) Load/no load	Standard stroke (mm)							Duty Cycle %	Max Current (A)	
					102	153	203	254	305	457	610		24VDC	12VDC
5:1	2500	2500	13600	47/67	102	153	203	254	305	457	610	25	14	28
10:1	3500	3500	13600	26/33	102	153	203	254	305	457	610	25	9	18
20:1	4500	4500	13600	14/17	102	153	203	254	305	457	610	25	7	15
30:1	6000	6000	13600	10/11	102	153	203	254	305	457	610	25	7	15
40:1	<b>7000</b>	<b>7000</b>	<b>13600</b>	<b>7/8</b>	<b>102</b>	<b>153</b>	<b>203</b>	<b>254</b>	<b>305</b>	<b>457</b>	<b>610</b>	<b>25</b>	<b>6</b>	<b>12</b>
Retracted Length					302	353	404	455	506	735	888			
POT/LT retracted length					<b>399</b>	<b>450</b>	<b>501</b>	<b>552</b>	<b>680</b>	<b>832</b>	<b>985</b>			

Stocked items in bold – 40:1 ratio with limits and POT

### Model coding

**ID10 -**

**24 -**

**Voltage**  
12-12V DC  
24-24V DC

**20 -**

**Gear Ratio**  
5-5:1  
10-10:1  
20-20:1  
30-30:1  
40-40:1

**B -**

**A:** Acme  
**B:** Ball Screw

**153 -**

**Stroke (mm)**  
102  
153  
203  
254  
305  
457  
610

**LT.POT.MD...**

**LT:** Limit switch  
**POT:** Potentiometer  
**MD:** Manual Drive  
**IP65**



## Other types and options



High load LAN3 – 1000N thrust with feedback, spline and safety nut options.



Foot switches and overload protection boxes



Key pads from 1 to 5 axis and foot switch option



Controllers for 1 to 6 axes. Plug and play functionality, battery operated, synchronised and simultaneous movements possible.



Heavy industrial AC actuators with high duty cycle, loads and wide speed range.



Screw jacks in ACME or ball screw, travelling nut or travelling screw layouts