

LED 025 Light with magnet mount

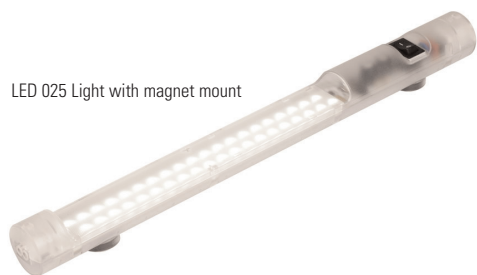

LED 025 Light with screw mount



The LED 025 light series is suitable for all types of panels and enclosures, especially where space is at a premium. These lights have a very long service life due to the use of LED technology. They are available with powerful non-slip rubberized magnets allowing them to be easily positioned in any steel enclosure. Screw mounting is also available as an option. The power output allows up to 10 lights to be connected to each other (daisy chain) with both the input and output plugs snap-locking into place.

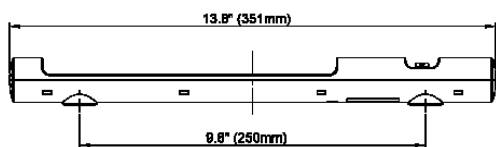

On/off switch light w/magnet mount

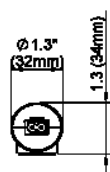

Magnet mount end view

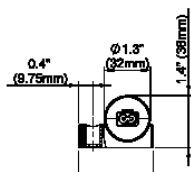

Screw mount end view

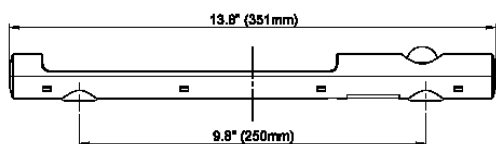

Motion sensor light w/magnet mount

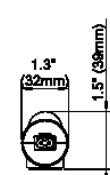

Magnet mount end view

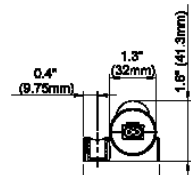

Screw mount end view



Technical Data

Power consumption	max. 5W (~ 75W incandescent bulb)
Luminosity	900Lm
Lamp type	LED, 120° angle of radiation light color - daylight, color temperature - 6,500K
Service life	60,000 hrs. at 68°F (20°C)
Connection	2-pole plug with snap lock AC: max. 2.5A / 240VAC, white cable DC: max. 2.5A / 60VDC, blue cable
Housing	plastic, transparent
Mounting	magnet or M5 screws, 9.8" (250mm) centers
Operating temperature	-22 to +140°F (-30 to +60°C)
Storage temperature	-40 to +185°F (-40 to +85°C)
Dimensions	magnet mount - 13.8 x 1.3 x 1.3" (351 x 34 x 32mm) screw mount - 13.8 x 1.4 x 1.3" (351 x 36 x 32mm)
Protection class	II (double insulated)
Protection type	IP20
Accessories	input and output plug, cable for supply or connection
Approvals	UL File No. E234324, VDE intended
Note	available with a 19" front panel

Part No. - magnet mount	Part No. - screw mount	Operating voltage	Switch type	Weight
02540.0-00	02540.0-01	100-240VAC, 50/60Hz (min. 90VAC, max. 265VAC)	on/off switch	4.8 oz. (135g)
02540.1-00	02540.1-01	24-48VDC (min. 20VDC, max. 60VDC)	on/off switch	4.8 oz. (135g)
02541.0-00	02541.0-01	100-240VAC, 50/60Hz (min. 90VAC, max. 265VAC)	PIR motion sensor ¹⁾	5.0 oz. (140g)
02541.1-00	02541.1-01	24-48VDC (min. 20VDC, max. 60VDC)	PIR motion sensor ¹⁾	5.0 oz. (140g)

¹⁾Passive Infrared (PIR) motion sensor is factory pre-set to turn the light off 6 minutes after all motion ceases

Specifications are subject to change without notice. Suitability of this product for its intended use and any associated risks must be determined by the end customer/ buyer in its final application.